

Kozy-World®

LIQUID PROPANE CONVERSION SAFETY PILOT KIT

Model #20-8113

FOR USE WITH MODELS

GLV018

GLV024

GLV030

⚠ WARNING:

This conversion kit shall be installed by a qualified service agency in accordance with the manufacturer's instructions and all applicable codes and requirements of the authority having jurisdiction. The information in these instructions must be followed to minimize the risk of fire or explosion or to prevent property damage, person injury or death. The qualified service agency performing this work assumes responsibility for the proper conversion of this appliance with the kit.

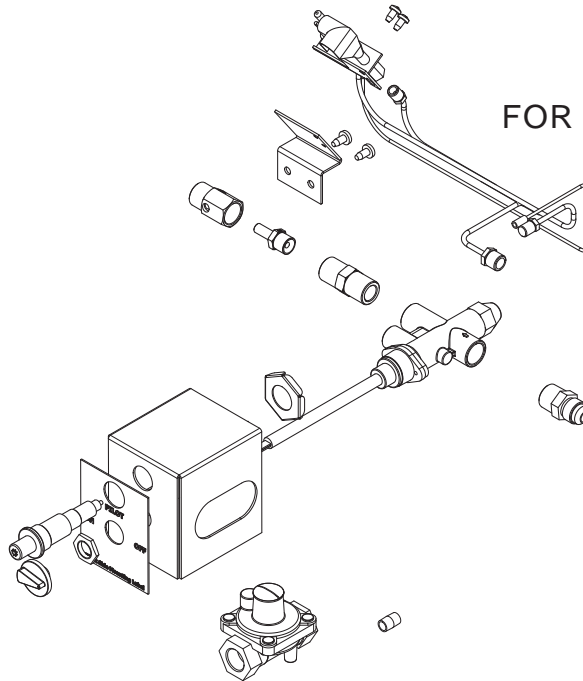

0418GL012S

ANSI Z21.60-2012

⚠ CAUTION - FOR YOUR SAFETY

⚠ WARNING: IF THE INFORMATION IN THIS MANUAL IS NOT FOLLOWED EXACTLY, A FIRE OR EXPLOSION MAY RESULT CAUSING PROPERTY DAMAGE, PERSONAL INJURY OR LOSS OF LIFE.

- Do not store or use gasoline or other flammable vapors and liquids in the vicinity of this or any other appliance.
- WHAT TO DO IF YOU SMELL GAS
 - Do not try to light any appliance.
 - Do not touch any electrical switch; do not use any phone in your building.
 - Immediately call your gas supplier from a neighbor's phone. Follow the gas supplier's instructions.
 - If you cannot reach your gas supplier, call the fire department.
- Installation and service must be performed by a qualified installer, service agency or the gas supplier.

**INSTALLER: Leave this manual with the appliance.
CONSUMER: Retain this manual for future reference.**



Questions, problems, missing parts? Before returning to your retailer, call our Technical Service Department at 1-814-643-1775.

IMSPKW - 2015-07-10

TABLE OF CONTENTS

Specifications	3
Important Safety Information	4
Product Identification	5
Product Features	6
Unpacking.....	6
Preparing for Installation.....	7
Installation	8
Operation.....	12
Troubleshooting	16
Replacement Parts	17
Placement of Decals.....	18-19
Uninstallation & Conversion Back to Natural Gas	20
Warranty	21

The charts indicate technical information regarding the installation of your gas log set.

Please make sure that all of the specifications shown are applicable before installation is attempted.

SPECIFICATIONS

Note: *This vented appliance must be installed only in a solid-fuel burning fireplace with a working flue and constructed of noncombustible material.*

Solid fuels shall not be burned in a fireplace where a decorative appliance is installed.

High Altitude Locations:

For high altitude installations in the United States, refer to the American Gas Association guidelines for the gas designed appliance derating method. For elevations above 2,000 ft (610 m), input ratings are to be reduced by 4% for each 1,000 ft (305 m) above sea level.

Model	GLV018	GLV024	GLV030
Input Rating	35,000 BTU/hr	45,000 BTU/hr	55,000 BTU/hr
Gas Type	LP	LP	LP
Ignition Type	Piezo Ignitor	Piezo Ignitor	Piezo Ignitor
Max. Inlet Pressure	14" WC	14" WC	14" WC
Min. Inlet Pressure	11" WC	11" WC	11" WC
Manifold Pressure	10" WC	10" WC	10" WC

SPECIFICATIONS

IMPORTANT: Read this owner's manual carefully and completely before trying to assemble, operate, or service this log set. Improper use of this log set can cause serious injury or death from burns, fire, explosion, electrical shock, and carbon monoxide poisoning.

Only a qualified installer, service agent, or local gas supplier may install and service this product.

 **WARNING:** Do not store or use gasoline or other flammable vapors or liquids in the vicinity of this or any other appliance.

 **WARNING:** The log set is shipped from the factory adjusted for natural gas use only. Liquid Propane can only be used after installation of Liquid Propane Conversion Safety Pilot Kit.

CARBON MONOXIDE POISONING: Early signs of carbon monoxide poisoning resemble the flu with headaches, dizziness, or nausea. If you have these signs, the log set may not be working properly. Get fresh air immediately! Have log set serviced. Some people are more affected by carbon monoxide than others. These include pregnant women, people with heart or lung disease, people who are anemic, those under the influence of alcohol, and those living in high altitudes.

NATURAL AND PROPANE/LP GAS: Natural and Propane/LP gases are odorless. An odor-making agent is added to the gas. The odor helps you detect a gas leak. However, the odor added to the gas can fade. Gas may be present even though no odor exists. Make certain you read and understand all warnings. Keep this manual for reference. It is your guide to operating this log set safely.

WARNING:

- Due to high temperatures, locate this appliance out of traffic and away from furniture and draperies.
- Log set becomes very hot when operating. Keep children and adults away from hot surfaces to avoid burns or clothing ignition. Log set will remain hot for a time after shut-off. Allow surfaces to cool before touching.
- Carefully supervise young children when they are in the room with the log set.
- Do not place clothing or other flammable material on or near the appliance. Never place any objects in the log set.
- Installation and repair should be done by a qualified service person. The appliance should be inspected before use and at least annually by a professional service person. More frequent cleaning may be required due to excessive lint from carpeting, bedding material, etc. It is imperative that control compartments, burners and circulating air passageways of the appliance be kept clean.
- Any change to this log set or its controls can be dangerous.
- Do not use any accessories not approved for use with this log set.
- Keep the appliance area clear and free from combustible materials, gasoline, and other flammable vapors and liquids.

CALIFORNIA PROPOSITION 65

Fuels used in gas or oil fired appliances and the products of combustion of such fuels contain chemicals known to the state of California to cause cancer, birth defects or other reproductive harm. This product contains chemicals, including lead and lead compounds, known to the state of California to cause cancer, birth defects or other reproductive harm. ***Wash hands after handling.***

SAFETY INFORMATION

1. This appliance is only for use with the type of gas indicated on the rating plate.
2. Do not place propane/LP supply tank(s) inside any structure. Locate propane/LP supply tank(s) outdoors.
3. If you smell gas
 - shut off gas supply
 - do not try to light any appliance
 - do not touch any electrical switch; do not use any phone in your building
 - immediately call your gas supplier from a neighbor's phone. Follow the gas supplier's instructions
 - if you cannot reach your gas supplier, call the fire department
4. This log set shall not be installed in a bedroom or bathroom.
5. Do not use this log set as a wood-burning log set. Use only the logs provided with the log set.
6. Do not add extra logs or ornaments such as pine cones, vermiculite or rock wool. Using these added items can cause sooting.
7. This log set is designed to be smokeless. If logs ever appear to smoke, turn off log set and call a qualified service person. Note: During initial operation, slight smoking could occur due to log curing and log set burning manufacturing residues.
8. To prevent the creation of soot, follow the instructions in Cleaning and Maintenance in your Vented Log Set Owners Manual.
9. Before using furniture polish, wax, carpet cleaner or similar products, turn log set off. If heated, the vapors from these products may create a white powder residue within burner box or on adjacent walls or furniture.
10. This log set needs fresh air ventilation to run properly.
11. Do not run log set
 - where flammable liquids or vapors are used or stored.
 - under dusty conditions.
12. Do not use this log set to cook food or burn paper or other objects.
13. Never place any objects in the fireplace or on the logs.
14. Do not use log set if any part has been under water. Immediately call a qualified service technician to inspect the log set and to replace any part of the control system and any gas control which has been under water.
15. Turn off and unplug log set and let cool before servicing. Only a qualified service person should service and repair log set.
16. To prevent performance problems, do not use propane/LP fuel tank of less than 100 lb. capacity.
17. Provide adequate clearances around air openings.

QUALIFIED INSTALLING AGENCY

Only a qualified agency should install and replace gas piping, gas utilization equipment or accessories, and repair and equipment servicing. The term "qualified agency" means any individual, firm, corporation, or company that either in person or through a representative is engaged in and is responsible for:

- a) Installing, testing, or replacing gas piping or
- b) Connecting, installing, testing, repairing, or servicing equipment; that is experienced in such work; that is familiar with all precautions required; and that has complied with all the requirements of the authority having jurisdiction.

PRODUCT IDENTIFICATION

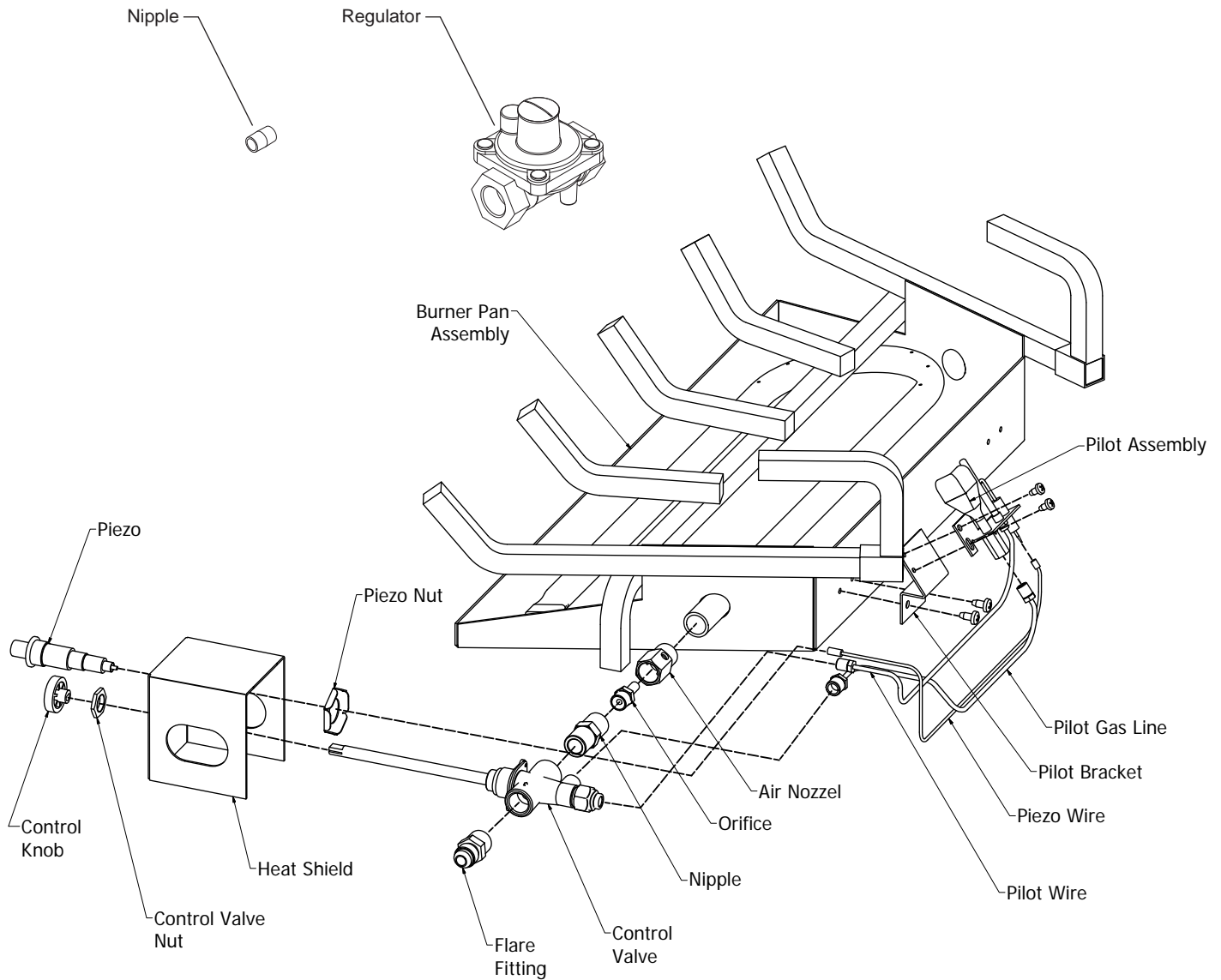

Notice: Use caution not to damage or break the aluminum pilot wire when routing and connecting.

PRODUCT FEATURES

LIQUID PROPANE CONVERSION & SAFETY PILOT

This system requires no matches, batteries, or other sources to light. You must use this optional system for Propane/LP conversion.

The State of Massachusetts requires that the chimney flue damper, when used with decorative gas log sets, be welded open or completely removed. In the State of Massachusetts, this appliance must be installed by a licensed plumber or gasfitter.

In the State of Massachusetts the gas cock must be a T-handle type. The State of Massachusetts requires that a flexible appliance connector cannot exceed three feet in length.

LOCAL CODES

Install and use log set with care. Follow all codes. In the absence of local codes, use the latest edition of The National Fuel Gas Code, ANSI Z223.1, also known as NFPA 54*.

*Available from:

American National Standard Institute, Inc.
1430 Broadway
New York, NY 10018

National Fire Protection Association, Inc.
1 Batterymarch Park
Quincy, MA 02269-9101

UNPACKING

⚠ CAUTION: Do not remove the metal data plates from the burner pan. The data plates contain important product information.

1. Remove logs, pan materials, and hardware from carton.
2. Remove all protective packaging applied to logs and base for shipment.
3. Check all items for any shipping damage. If damaged, promptly inform dealer where you bought the product.

PREPARING FOR INSTALLATION

This safety pilot system must be installed by a qualified profession service technician.

Before beginning assembly of product, make sure all parts are present. Compare parts with package contents list. If any part is missing or damaged, do not attempt to assemble the product. Contact customer service for replacement parts.

Estimated Assembly Time: 60 minutes

Tools Required for Assembly (not included): Philips Screwdriver, Pipe Sealant, Adjustable Wrench Sediment Trap and Manual Shutoff Valve.

INSTALLATION

This safety pilot system must be installed by a qualified profession service technician.

Note: Installation is easier when done outside of the fireplace.
Save the orifices removed from the appliance for future use.

Liquid Propane Conversion Safety Pilot Kit Assembly Instructions

1. Determine which side of the burner assembly the control will be on – Left or Right and attach ON□OFF Label to Valve Bracket.
-This assembly illustration shows the control on the right side.

2. Attach Piezo Ignitor to Valve Bracket.

3. Attach Valve to Valve Bracket.

4. Install Knob to Valve.

5. Attach Nozzle to Burner Pan.

WARNING: Failure to position the parts in accordance with these diagrams or failure to use only parts specifically approved with this appliance may result in property damage or personal injury.

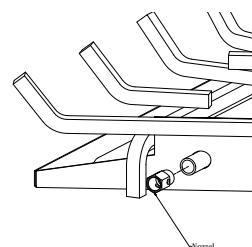
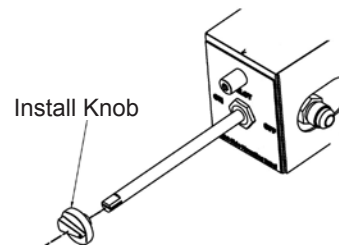
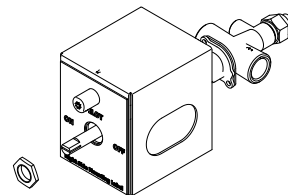
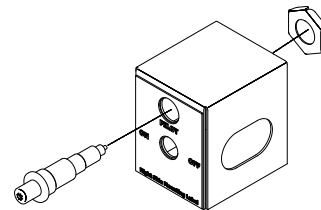
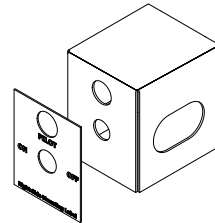

INSTALLATION

6. a. Attach Threaded Nipple to Valve.
b. Install proper Orifice for the size Log Set into Threaded Nipple.
c. Install Flare Fitting to inlet of Valve.

Note: Save the orifices removed from the appliance for future use.

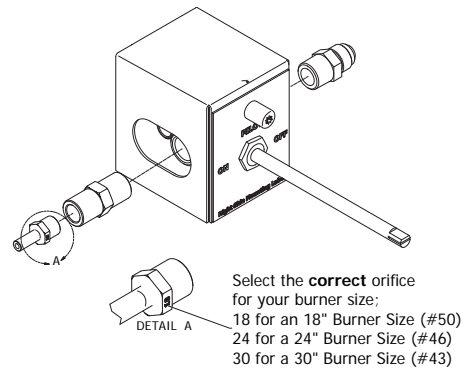

7. Attach Orifice to Nozzle by rotating the complete Valve Bracket Assembly. Tighten securely until Valve Bracket Assembly is level with burner pan.

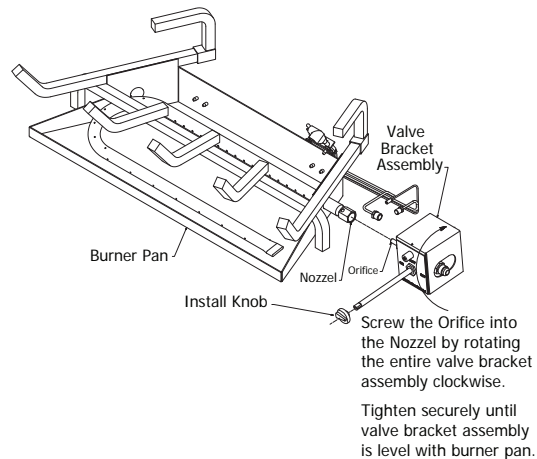

8. Attach Pilot Bracket and Pilot Assembly to Burner Pan.

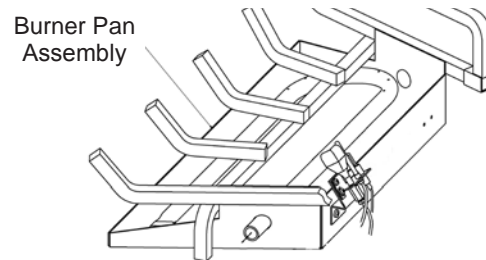

9. Notice: Use caution not to damage or break the aluminum pilot wire when routing and connecting.
 - a. Connect Pilot Gas Line to Valve. Finger tight quarter turn.
 - b. Connect Thermocouple Wire to Valve. Finger tight, quarter turn.
 - c. Connect Piezo Wire to Piezo

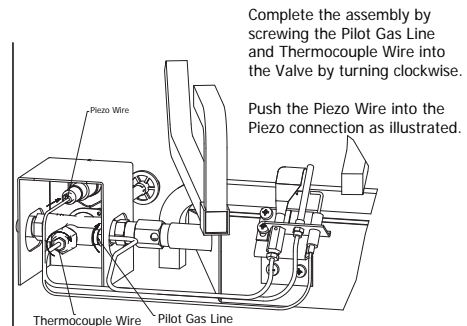

INSTALLATION

CONNECTION TO GAS SUPPLY

⚠ WARNING: A qualified service person must connect log set to gas supply. Follow all local codes.

Installation Items Needed

Before installing log set, make sure you have the items listed below.

- piping (check local codes)
- sealant (resistant to natural gas)
- equipment shutoff valve
- test gauge connection
- adjustable (crescent) wrench or pliers
- sediment trap
- tee joint
- pipe wrench

⚠ CAUTION: Only use a new, black iron or steel pipe. Internally-tinned copper tubing may be used in certain areas. Check your local codes. Use pipe of 1/2" diameter or greater to allow proper gas volume to log set. If pipe is too small, loss of pressure will occur.

Installation must include an equipment shutoff valve, union, and plugged 1/8" NPT tap. Locate NPT tap within reach for test gauge hook up. NPT tap must be upstream from log set (see Figure 1).

IMPORTANT: Install equipment shutoff valve in an accessible location. The equipment shutoff valve is for turning on or shutting off the gas to the appliance.

Apply pipe joint sealant lightly to male threads. This will prevent excess sealant from going into pipe. Excess sealant in pipe could result in a clogged burner injector.

Install sediment trap in supply line. Locate sediment trap where it is within reach for cleaning. Locate sediment trap where trapped matter is not likely to freeze. A sediment trap traps moisture and contaminants. This keeps them from going into log set controls. If sediment trap is not installed or is installed incorrectly, log set may not run properly.

Fig. 1

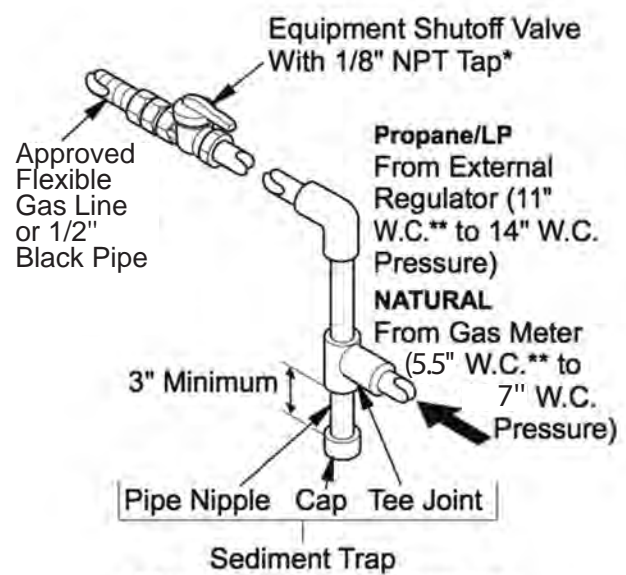

INSTALLATION

CHECKING GAS CONNECTIONS

⚠ WARNING: Test all gas piping and connections for leaks after installing or servicing. Correct all leaks immediately.

⚠ WARNING: Never use an open flame to check for a leak. Apply a mixture of liquid soap and water to all joints. If bubbles form, there may be a leak. Correct all leaks immediately.

Pressure Testing Gas Supply Piping System Test Pressures In Excess Of 1/2 PSIG (3.5kPa)

1. Disconnect log set with its appliance main gas valve (control valve) and equipment shutoff valve from gas supply piping system. Pressures in excess of 1/2 PSIG will damage log set regulator.
2. Cap off open end of gas pipe where equipment shutoff valve was connected.
3. Pressurize supply piping system by either using compressed air or opening gas supply tank valve.
4. Check all joints of gas supply piping system. Apply mixture of liquid soap and water to gas joints. If bubbles form, there may be a leak.
5. Correct all leaks immediately.
6. Reconnect log set and equipment shutoff valve to gas supply. Check reconnected fittings for leaks.

Test Pressures Equal To or Less Than 1/2 PSIG (3.5 kPa)

1. Close equipment shutoff valve (See Fig. 2).
2. Pressure supply piping system by either using compressed air or opening gas supply tank valve.
3. Check all joints from gas meter to equipment shutoff valve (See Fig. 3 & 4). Apply mixture of liquid soap and water to gas joints. If bubbles form, there may be a leak.
4. Correct all leaks immediately.

Pressure Testing Log set Gas Connections

1. Open equipment shutoff valve (See Fig. 2).
2. Open gas supply tank valve.
3. Make sure control knob of log set is in the OFF position.
4. Check all joints from equipment shutoff valve to control valve (See Fig. 3 & 4). Apply mixture of liquid soap and water to gas joints. If bubbles form, there may be a leak.
5. Light log set (see Operation, page 12).
Check all other internal joints for leaks.
6. Turn off log set (see "To Turn Off Gas to Appliance," page 12).

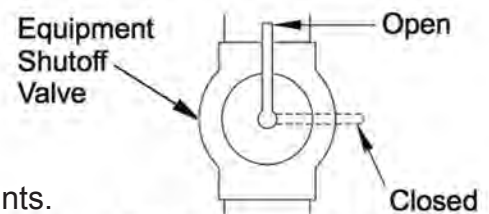
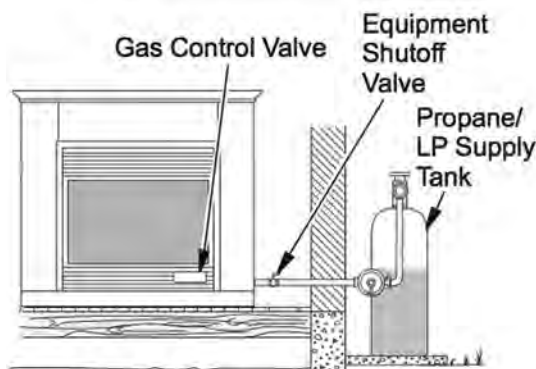
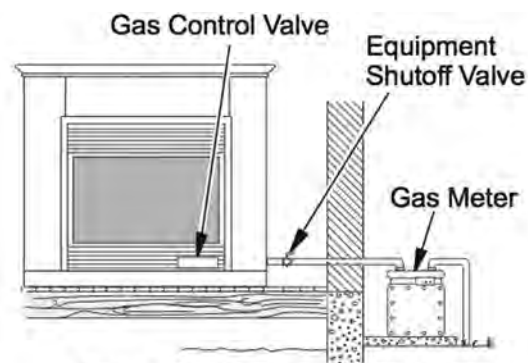

Fig. 2 - Equipment Shutoff Valve



**Fig. 3 - Checking Gas Joints
(Propane/LP Only)**



**Fig. 4 - Checking Gas Joints
(Natural Gas Only)**

To convert the back to original gas first make sure the equipment shutoff valve is closed (see Fig 2.). Simply disconnect the LP conversion kit's "Air Nozzle" from the appliance with a wrench. Refer to owner's manual for more detail regarding

OPERATION

FOR YOUR SAFETY READ BEFORE LIGHTING



WARNING: If you do not follow these instructions exactly, a fire or explosion may result causing property damage, personal injury or loss of life.

A. This appliance has a pilot which must be lighted by the electronic ignitor. When lighting the pilot, follow these instructions exactly.

B. **BEFORE LIGHTING** smell all around the appliance area for gas. Be sure to smell next to the floor because some gas is heavier than air and will settle on the floor.

WHAT TO DO IF YOU SMELL GAS

- Do not try to light any appliance.
- Do not touch any electrical switch; do not use any phone in your building.
- Immediately call your gas supplier from a neighbor's phone. Follow the gas supplier's instructions.
- If you cannot reach your gas supplier, call the fire department

C. Use only your hand to push in or turn the gas control knob. Never use tools. If the knob will not push in or turn by hand, don't try to repair it, call a qualified service technician. Forced or attempted repair may result in fire or explosion.

D. Do not use this appliance if any part has been under water. Immediately call a qualified service technician to inspect the appliance and to replace any part of the control system and any gas control which has been under water.

E. Solid fuels shall not be burned in a fireplace where a decorative appliance is installed.

F. A fireplace screen must be in place when the appliance is operating and, unless other provisions for combustion air are provided, the screen shall have an opening(s) for introduction of combustion air.

LIGHTING INSTRUCTIONS

LIGHTING THE PILOT

1. STOP! Read the safety information as noted above.



WARNING: BE SURE THAT THE CHIMNEY DAMPER IS FULLY OPEN.

IMPORTANT: Verify the input rating of the converted appliance with the table on page 2.



2. Read all warnings and safety information in this manual
3. Locate the valve on the side of the unit, and push the gas control knob in slightly (DO NOT FORCE) and turn clockwise  to OFF (See Fig. 5).
4. Wait five (5) minutes to clear out any gas. If you smell gas, STOP! Follow the safety instructions on the previous page named "WHAT TO DO IF YOU SMELL GAS". If you do not smell gas, continue onto the next step.
5. Slightly push in, and turn the control knob counterclockwise  so the white dot on the control knob lines up with "PILOT" (See Fig. 6). The pilot is visible, at the back of the burner on the valve side. (See Fig. 6.5).
- Do not attempt to light the pilot by hand.
6. Push firmly and hold the control knob in fully and hold.
7. With control knob depressed, repeatedly push down the piezo ignitor  until the pilot lights.

Fig. 5

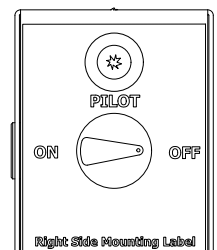
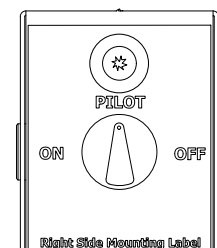

Fig. 6



LIGHTING INSTRUCTIONS (Continued)

8. Keep control knob depressed for (30) seconds after pilot lights. Release control knob.

- If the control knob does not pop up when released, stop and immediately call a qualified service technician or gas supplier.
- If pilot goes out repeat steps 3 through 7. Wait (1) minute before attempting to light pilot again. If after several tries the pilot still goes out, turn the gas control knob clockwise to the "OFF". position and call a qualified service technician.

Fig. 6.5

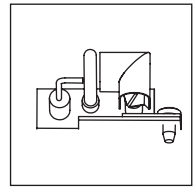
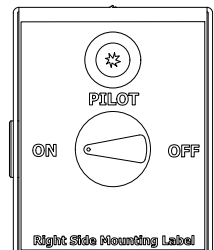



Fig. 7



LIGHTING THE BURNER

1. Ensure the pilot is lit. Turn the gas control knob counterclockwise  to the "ON" position (See Fig. 7)

⚠ WARNING: If the burner fails to light within 5 seconds, turn the control knob clockwise to the "PILOT" position. Wait five (5) minutes to clear out any gas. If you smell any gas STOP! Follow the safety instructions on the previous page names "WHAT TO DO IF YOU SMELL GAS." If you do not smell gas, continue on to the next step.

⚠ WARNING: If after several tries the pilot still goes out, turn the gas control knob clockwise to the "OFF" position and call a qualified service technician.

⚠ WARNING: The fireplace screen must be in place when the appliance is operating and, unless other provisions for combustion are provided, the screen shall have an opening(s) for introduction of combustion air.

⚠ WARNING: Any glass doors shall be completely opened while appliance is in operation.

TO TURN OFF GAS TO APPLIANCE

1. Push in the control knob slightly and turn all the way clockwise , so the white dot is pointing to the "OFF" position.

Note: Verify that the unit operates in accordance to these lighting instructions

OPERATION

INSPECTING BURNERS

Check pilot flame pattern daily when in use and at least yearly by a qualified service agency.

PILOT FLAME PATTERN

Fig. 8 shows a correct pilot flame pattern. Fig. 9 shows an incorrect pilot flame pattern. The incorrect pilot flame is not touching the thermocouple. This will cause the thermocouple to cool, which shuts the heater off. If pilot flame pattern is incorrect:

- turn heater off (see “To Turn Off Gas to Appliance” on page 13)
- see Troubleshooting pages 16.

Fig. 8 - Correct Pilot Flame Pattern

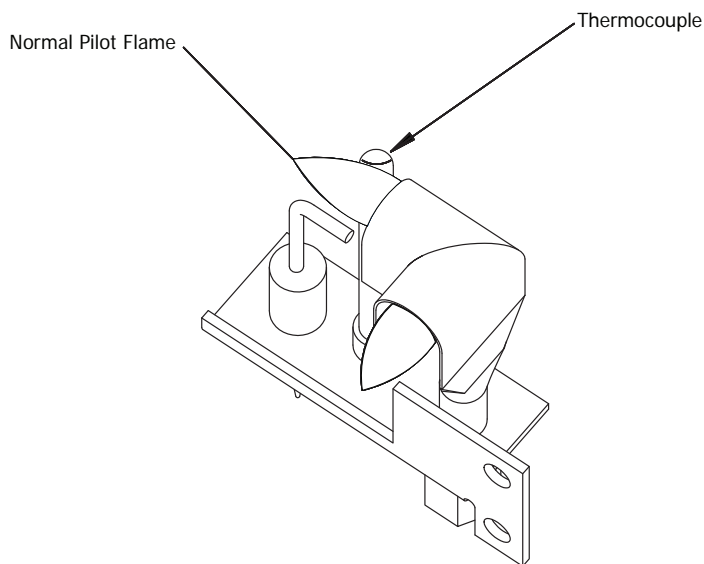

LP Pilot Assembly

Fig. 9 - Incorrect Pilot Flame Pattern

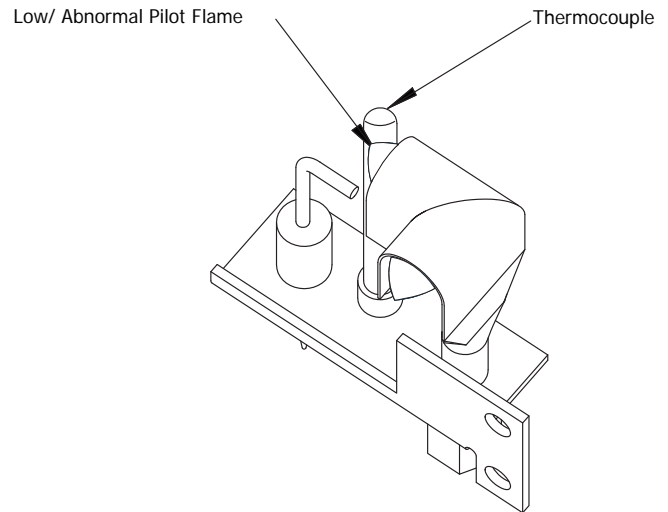

LP Pilot Assembly

⚠ WARNING: If yellow tipping occurs, your heater could produce increased levels of carbon monoxide. If burner flame pattern shows yellow tipping, follow instructions at bottom of this page.

⚠ WARNING: Do not allow fans to blow directly into the heater. Avoid any drafts that alter burner flame patterns.

⚠ WARNING: Do not use a blower insert, heat exchanger insert or other accessory not approved for use with this heater.

Notice: Do not mistake orange flames with yellow tipping. Dirt or other fine particles enter the heater and burn causing brief patches of orange flame.

OPERATION

BURNER FLAME PATTERN

Figure 10 shows a correct burner flame pattern. Figure 11 shows an incorrect burner flame pattern. The incorrect burner flame pattern shows sporadic, irregular flame tipping. The flame should not be dark or have an orange/reddish tinge.

Note: When using the log set the first time, the flame will be orange for approximately one hour until the log cures.

If burner flame pattern is incorrect, as shown in Figure 11.

- turn log set off (see To Turn Off Gas to Appliance, page 13).
- see Troubleshooting, page 16.

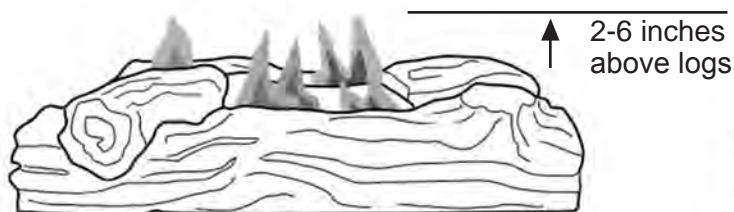

Fig. 10 - Correct/Normal Flame Pattern with short flames



Fig. 11 -Incorrect/Abnormal Flame Pattern with tall flames

⚠ WARNING: Turn off log set and let cool before servicing.

⚠ CAUTION: You must keep control areas, burner, and circulating air passageways of log set clean. Inspect these areas of log set before each use. Have log set inspected yearly by a qualified service person. Log set may need more frequent cleaning due to excessive lint from carpeting, bedding material, pet hair, etc.

⚠ WARNING: Failure to keep the primary air opening(s) of the burner(s) clean may result in sooting and property damage.

BURNER ORIFICE HOLDER AND PILOT AIR INLET HOLE

The primary air inlet holes allow the proper amount of air to mix with the gas. This provides a clean burning flame. Keep these holes clear of dust, dirt, lint and pet hair. Clean these air inlet holes prior to each heating season. Blocked air holes will create soot. We recommend that you clean the unit every three months during operation and have log set inspected yearly by a qualified service person.

We also recommend that you keep the burner tube and pilot assembly clean and free of dust and dirt. To clean these parts we recommend using compressed air no greater than 30 PSI. Your local computer store, hardware store or home center may carry compressed air in a can. If using compressed air in a can, please follow the directions on the can. If you don't follow directions on the can, you could damage the pilot assembly.

Periodic examination and cleaning of the venting system and the solid fuel-burning fireplace, including frequency of such examination and cleaning, must be done by a qualified agency.

TROUBLESHOOTING

⚠ WARNING: If you smell gas:

- Shut off gas supply.
- Do not try to light any appliance.
- Do not touch any electrical switch; do not use any phone in your building.
- Immediately call your gas supplier from a neighbor's phone. Follow the gas supplier's instructions.
- If you cannot reach your gas supplier, call the fire department.

IMPORTANT: Operating log set where impurities in air exist may create odors. Cleaning supplies, paint, paint remover, cigarette smoke, cements and glues, new carpet or textiles, etc., create fumes. These fumes may mix with combustion air and create odors.

⚠ WARNING: Turn off and let cool before servicing. Only a qualified service person should service and repair log set.

PROBLEM	POSSIBLE CAUSE	CORRECTIVE ACTION
Pilot will not light	1. Obstruction in pilot gas-supply or pilot gas supply line is kinked 2. Inadequate gas supply 3. Air in line	1. Clear out obstruction. Replace pilot gas-supply line if kinked 2. Have gas pressure checked by installer or gas installer 3. Let air clear; attempt to relight
Pilot will not stay lit after releasing knob	1. Thermocouple connection to valve is either too tight or too loose 2. Bad thermocouple	1. Ensure thermocouple is finger tight and then 1/8" turn with a wrench 2. Replace thermocouple
Log set extinguishes a few minutes after lighting	1. Inadequate gas supply causes pilot flame to reduce after burner lights	1. Using pilot adjustment, increase gas to pilot. Pilot flame must be in contact with the thermocouple tip
Log set extinguishes after burning for some time (approximately 10 minutes - 1 hour)	1. Thermocouple has overheated; glass doors are closed 2. Thermocouple has overheated; burner flames are heating the thermocouple cold junction	1. Be sure glass doors are open during operation 2. Be sure the pilot assembly and the flame diverter are in their proper position. Re-arrange logs so the flame is not deflected to the thermocouple.

REPLACEMENT PARTS

For replacement parts, call our Technical Service Department at 1-814-643-1775, 8:30 a.m. –4:30 p.m., CST, Monday – Friday.

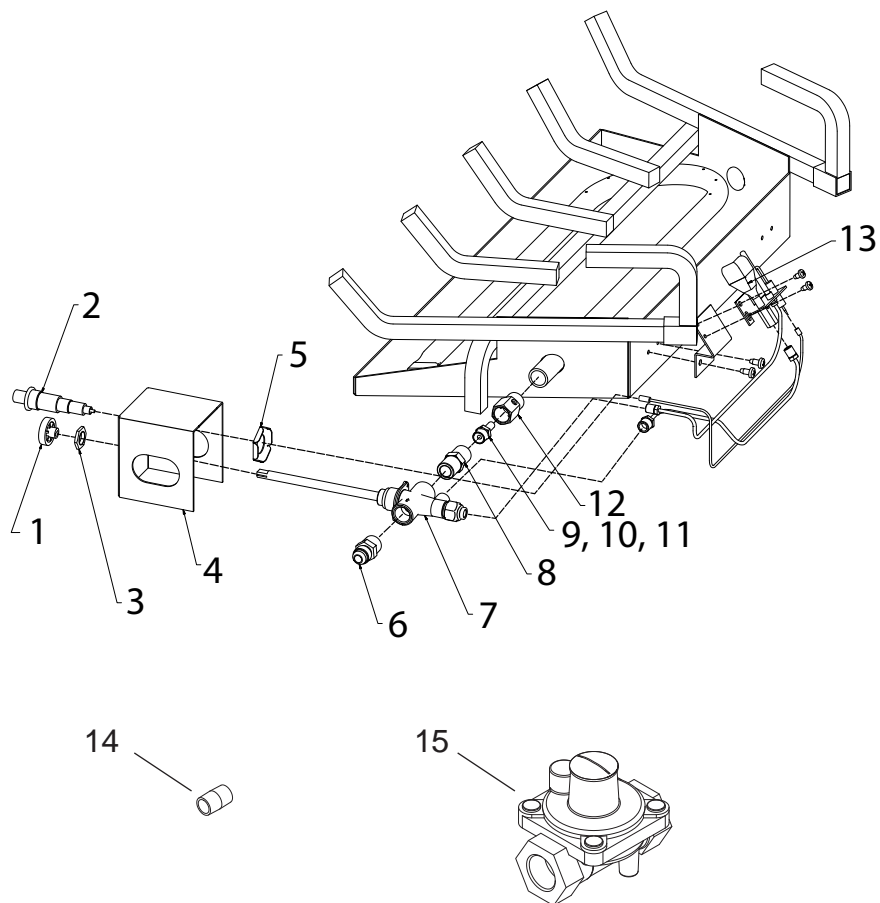

ITEM NO.	DESCRIPTION	QTY	Part No. 20-8113
1	Control Knob	1	GZ37-11
2	Piezo Ignitor	1	GZ37-09
3	Control Valve Nut	1	GS2A-11
4	Heat Shield	1	GS37-02
5	Piezo Nut	1	GZ37-09A
6	Brass fitting, 3/8" NPT x 3/8" Flare	1	GZ37-13
7	Control Valve	1	GZ-26
8	Nipple	1	GZ37-04
9	Orifice for 18" - #50	1	GZ37-05-18
10	Orifice for 24" - #46	1	GZ37-05-24
11	Orifice for 30" - #43	1	GZ37-05-30
12	Air Nozzle	1	GZ37-05
13	Pilot Assembly	1	GZ37-12
14	Nipple, Close 3/8"	1	JISB2302
15	Regulator, 10" H2O	1	AQ000073A

PLACING RATING TAG DECAL

⚠ WARNING: Information contained in the figures on this page may not be accurate or updated information. DO NOT use any information inside of these figures for installation or technical purposes. They are only to be used as a visual aid of how to place the decal.

After installing your new Kit #20-8113, you will need to update the information that is included on your decorative/vented appliance by applying the included decal:

- 1. Locate the Rating Tag Decal in the Kit #20-8113 packaging (See Figure 0.1)
- 2. Locate the Rating Tag hanging from the vented appliance (See Figure 0.2)
- 3. Rating Tag Decal will go where the white box is (See Figure 0.3)
- 4. Peel off and stick the Rating Tag Decal so it looks like Figure 0.4
- 5. Fill in date of conversion and name & address of company making the conversion on the newly applied decal

Fig 0.1

Model	<input type="checkbox"/>	<input type="checkbox"/>	<input type="checkbox"/>
Input Rating			
Gas Type			
Ignition Type			
Max. Inlet Pressure			
Min. Inlet Pressure			
Normal Pressure			

This appliance was converted on _____ (Day-Month-Year) to LP Gas with Kit Model# by _____ (Name, Address of Company making this conversion), which accepts the responsibility that this conversion has been properly made.

Fig 0.2

Serial Number:

Company Name
Street
City, State, ZIP

Complies with ANSI Z21.84-2012, Standard for Manually lighted, Natural Gas Decorative Gas Appliances for Installation in Solid-Fuel Burning Fireplaces.

Complies with ANSI Z21.60-2012, Standard for Decorative Gas Appliances for Installation in Solid-Fuel Burning Fireplaces when the LP Conversion Kit is installed by a qualified technician.

0418GL009S

Minimum Fireplace Size				
Log Size	Height	Depth	Front Width	Rear Width
18" Vented				
24" Vented				
30" Vented				

⚠ WARNING:

- Improper installation, adjustment, alteration, service, or maintenance can cause property damage, personal injury, or loss of life. Refer to the owner's manual provided with this heater. Installation and service must be performed by a qualified installer, service agency, or the gas supplier.
- For installation in a solid-fuel burning fireplace only. The fireplace chimney must have a permanent vent opening to atmosphere of not less than 50 square inches.
- A fireplace screen must be in place when the appliance is operating and, unless other provisions for combustion air are provided, the screen shall have an opening(s) for introduction of combustion air.
- Any glass doors shall be opened when the appliance is in operation.

Fig 0.3

Serial Number:

Company Name
Street
City, State, ZIP

Complies with ANSI Z21.84-2012, Standard for Manually lighted, Natural Gas Decorative Gas Appliances for Installation in Solid-Fuel Burning Fireplaces.

Complies with ANSI Z21.60-2012, Standard for Decorative Gas Appliances for Installation in Solid-Fuel Burning Fireplaces when the LP Conversion Kit is installed by a qualified technician.

0418GL009S

Minimum Fireplace Size				
Log Size	Height	Depth	Front Width	Rear Width
18" Vented				
24" Vented				
30" Vented				

⚠ WARNING:

- Improper installation, adjustment, alteration, service, or maintenance can cause property damage, personal injury, or loss of life. Refer to the owner's manual provided with this heater. Installation and service must be performed by a qualified installer, service agency, or the gas supplier.
- For installation in a solid-fuel burning fireplace only. The fireplace chimney must have a permanent vent opening to atmosphere of not less than 50 square inches.
- A fireplace screen must be in place when the appliance is operating and, unless other provisions for combustion air are provided, the screen shall have an opening(s) for introduction of combustion air.
- Any glass doors shall be opened when the appliance is in operation.

Fig 0.4

Serial Number:

Model	<input type="checkbox"/>	<input type="checkbox"/>	<input type="checkbox"/>
Input Rating			
Gas Type			
Ignition Type			
Max. Inlet Pressure			
Min. Inlet Pressure			
Normal Pressure			

This appliance was converted on _____ (Day-Month-Year) to LP Gas with Kit Model# by _____ (Name, Address of Company making this conversion), which accepts the responsibility that this conversion has been properly made.

Company Name
Street
City, State, ZIP

Complies with ANSI Z21.84-2012, Standard for Manually lighted, Natural Gas Decorative Gas Appliances for Installation in Solid-Fuel Burning Fireplaces.

Complies with ANSI Z21.60-2012, Standard for Decorative Gas Appliances for Installation in Solid-Fuel Burning Fireplaces when the LP Conversion Kit is installed by a qualified technician.

0418GL009S

Minimum Fireplace Size				
Log Size	Height	Depth	Front Width	Rear Width
18" Vented				
24" Vented				
30" Vented				

⚠ WARNING:

- Improper installation, adjustment, alteration, service, or maintenance can cause property damage, personal injury, or loss of life. Refer to the owner's manual provided with this heater. Installation and service must be performed by a qualified installer, service agency, or the gas supplier.
- For installation in a solid-fuel burning fireplace only. The fireplace chimney must have a permanent vent opening to atmosphere of not less than 50 square inches.
- A fireplace screen must be in place when the appliance is operating and, unless other provisions for combustion air are provided, the screen shall have an opening(s) for introduction of combustion air.
- Any glass doors shall be opened when the appliance is in operation.

PLACING LIGHTING TAG DECAL

⚠ WARNING: Information contained in the figures on this page may not be accurate or updated information. DO NOT use any information inside of these figures for installation or technical purposes. They are only to be used as a visual aid of how to place the decal.

After installing your new Kit #20-8113, you will need to update the information that is included on your decorative/vented appliance by applying the included decal:

1. Locate the Lighting Tag Decal in the Kit #20-8113 packaging (See Figure 0.5)
2. Locate the Lighting Tag hanging from the vented appliance (See Figure 0.6)
3. Lighting Tag Decal will go where the white box is (See Figure 0.7)
4. Peel off and stick the Lighting Tag Decal so it looks like Figure 0.8

Fig 0.5

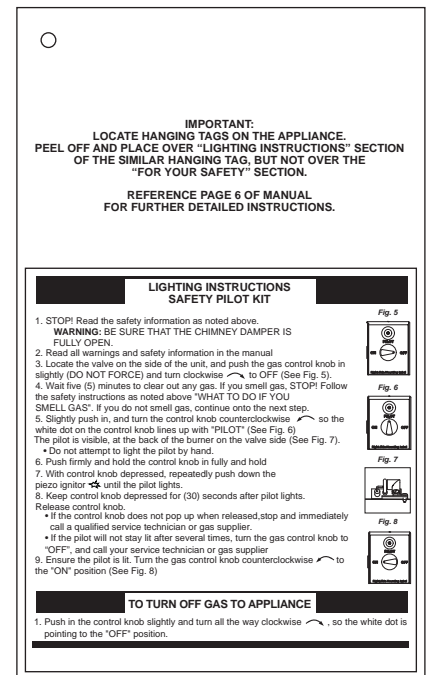

Fig 0.6

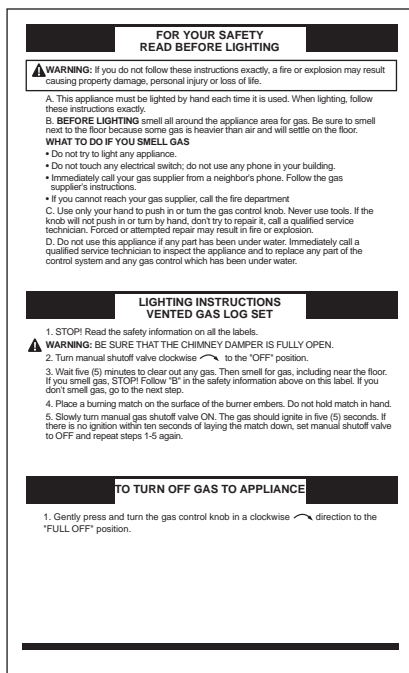

Fig 0.7

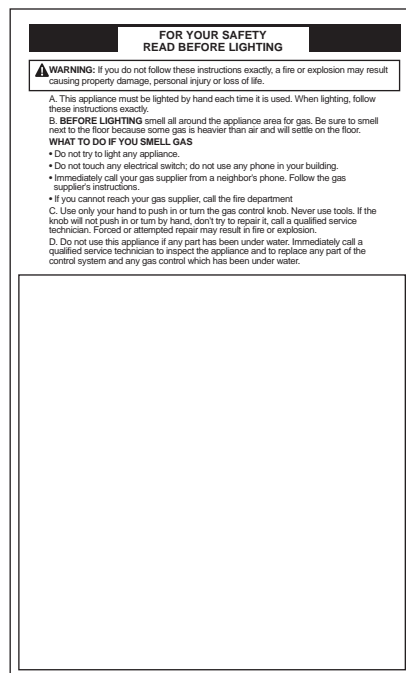
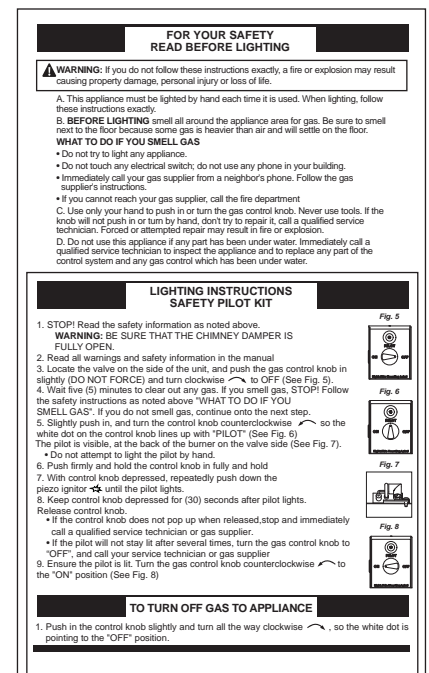

Fig 0.8



UNINSTALLATION & CONVERSION BACK TO NATURAL GAS

UNINSTALLATION OF LIQUID PROPANE CONVERSION SAFETY PILOT KIT (See Figure 12)

1. Insure the gas is shut off at the main shut-off valve
2. Remove the pilot assembly by unscrewing the (2) screws holding the pilot to the pilot bracket.
 - a. Unscrew the pilot tube from the Safety Pilot Kit (SPK) valve.
 - b. Unscrew the thermocouple line from the SPK valve.
 - c. Remove the piezo wire from the piezo starter
3. Remove the SPK assembly by rotating the entire assembly counter clockwise
4. Remove the nozzle from the burner tube by turning counter clockwise.

CONVERTING BACK TO NG FROM LP (See Figure 13)

- 1a. Thread the keyed shut-off valve to the fireplace gas supply pipe. Use thread sealant.
- 1b. If a keyed shut-off valve is already installed, thread 1/2" female connector to the fireplace gas supply pipe. Use thread sealant
2. Thread adapter fitting into keyed shut-off valve (or 1/2" Female Connector)
3. Install NG 3/8" orifice fitting onto the burner inlet fitting using thread sealant on male threads of burner inlet fitting.
NOTE: This fitting was supplied with the original Vented Gas Log model. If this is missing refer to the parts list in the Vented Gas Log Owners Manual, and order a new part. DO NOT operate the appliance without the correct orifice fitting (Item #80-06-034).
4. Install the gas flex tube to the adapter fitting. Carefully shape tube to attach to orifice fitting.

Fig. 12

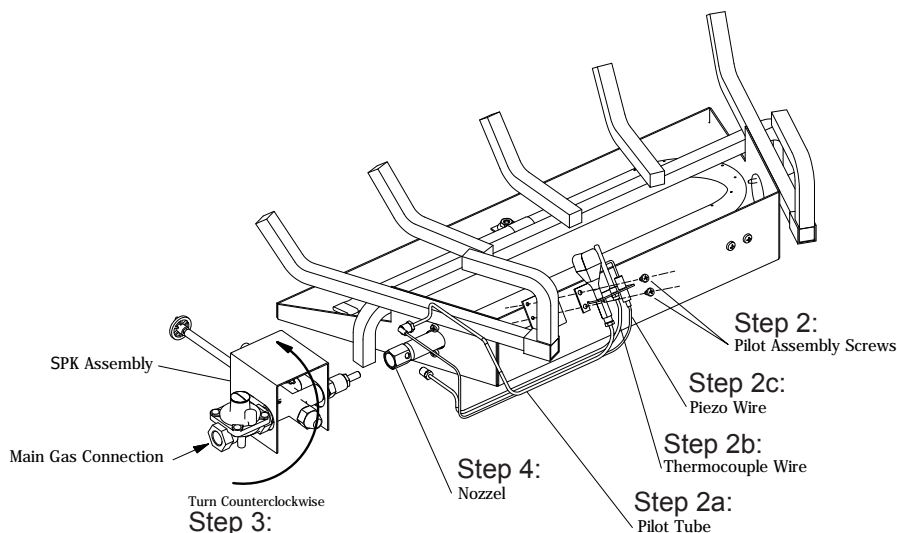
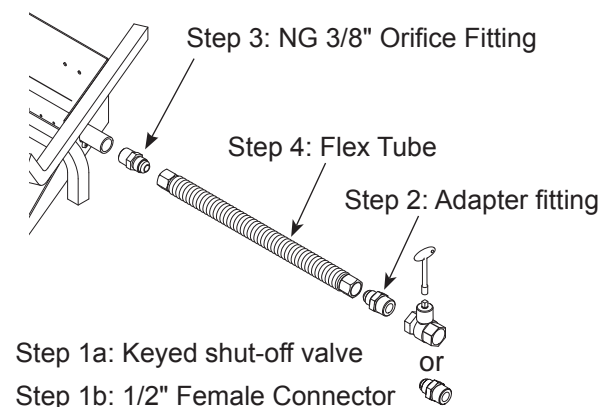

Fig. 13



KOZYWORLD® GAS APPLIANCE WARRANTY

LIMITED WARRANTY:

A limited warranty is extended to the original purchaser of this heater and warrants against malfunction due to manufacturing defects for a period of (1) one year from the date of retail purchase. Please read and follow all details noted below.

CLAIMS HANDLED AS FOLLOWS:

- DO NOT RETURN TO PLACE OF PURCHASE.

- Contact our Customer Service Department at 1-800-776-9425. You must have the model number, serial number and date of purchase.
- They will provide you with further instructions, which may include replacement parts, repair or replacement at our option.

CALL 1-800-776-9425 FOR SERVICE (9AM-6PM MON. - FRI.) or EMAIL US AT info@worldmkting.com

DUTIES OF THE OWNER:

This heating appliance must be installed and tested by a qualified individual and operated in accordance with the written instructions furnished with this appliance. This warranty shall not excuse the owner from properly maintaining this appliance in accordance with the written instructions furnished. A bill of sale, cancelled check or payment record must be kept to verify purchase date and establish warranty period. Original carton should be kept in case of warranty return of unit.

WHAT IS NOT COVERED:

1. Damage resulting from use of improper fuel.
2. Damage caused by misuse or use contrary to the owners manual and safety guidelines.
3. Damage caused by a lack of normal maintenance.
4. Use of non-standard parts or accessories.
5. Accessory items

LIMITATIONS:

This warranty does not imply or assume any responsibility for consequential damages that may result from the use, misuse, or the lack of routine maintenance of this heating appliance. A cleaning fee and the cost of parts may be charged for appliance failures resulting from lack of maintenance. This warranty does not cover claims which do not involve defective workmanship or materials. FAILURE TO PERFORM GENERAL MAINTENANCE (INCLUDING CLEANING) WILL VOID THIS WARRANTY.

THIS LIMITED WARRANTY IS GIVEN TO THE PURCHASER IN LIEU OF ALL OTHER WARRANTIES, EXPRESSED OR IMPLIED, INCLUDING BUT NOT LIMITED TO THE WARRANTIES OF MERCHANTABILITY OF FITNESS FOR A PARTICULAR PURPOSE. THE REMEDY PROVIDED IN THIS WARRANTY IS EXCLUSIVE AND IS GRANTED IN LIEU OF ALL OTHER REMEDIES. IN NO EVENT WILL WORLD MARKETING OF AMERICA BE LIABLE FOR INCIDENTAL OR CONSEQUENTIAL DAMAGES. Some states do not allow limitations on how long an implied warranty lasts, so the above limitation may not apply to you. Some states do not allow the exclusion or limitation of incidental or consequential damages so the above limitation or exclusion may not apply to you.

TO REGISTER THE WARRANTY ON YOUR APPLIANCE, PLEASE FILL OUT THIS CARD COMPLETELY AND MAIL OR REGISTER ON-LINE AT WORLDWMKTING.COM WITHIN 10 DAYS FROM DATE OF PURCHASE.

NAME: _____ PHONE: () _____
ADDRESS: _____ EMAIL: _____
CITY: _____ STATE: _____ ZIP: _____
MODEL: _____ SERIAL #: _____ DATE PURCHASED: _____
PURCHASED AT: _____ TYPE OF STORE: _____
CITY & STATE WHERE PURCHASED: _____ PRICE PAID: _____

Please Take a Minute To Give Us Your Answers To The Following Questions.

All Responses Are Used Solely For Market Research And Are Held In Strict Confidence.

Who primarily decided this purchase? ☐ Male ☐ Female ☐ 18-24 ☐ 25-39 ☐ 40-59 ☐ 60 and over

Occupation? ☐ Homemaker ☐ Operator/Laborer ☐ Professional ☐ Service Work ☐ Clerical

☐ Retired ☐ Student ☐ Other _____

Household income? ☐ Under \$20,000 ☐ \$20-39,000 ☐ \$40-59,000 ☐ \$60-79,000 ☐ Over \$80,000

Do you own any other heating appliances? ☐ Yes ☐ No If yes, type _____ brand _____

How do you intend to use your new heating appliance? ☐ Emergency Heat ☐ Extra Heat ☐ Decorative

How did you become aware of this appliance? ☐ In-Store Display ☐ Newspaper Ad ☐ Magazine Ad

☐ Friend/Relative ☐ TV Commercial ☐ Store Salesperson ☐ Other _____

What made you select this appliance? ☐ Style ☐ Size/Portability ☐ Durability ☐ Warranty ☐ Package

☐ Other _____

Do you: ☐ own ☐ rent Would you recommend this heater to a friend? ☐ Yes ☐ No

Please give us your comments: _____

BEFORE CALLING FOR SERVICE

- **Do Not Use Your Heater Without Checking For Leaks!** Leaks can occur during shipment and installation. A simple solution of soap and water dabbed on the fittings will bubble if a gas leak is present.
- **Wrong Gas Pressure!** Too much gas pressure may severely damage your heater. Too little gas pressure and your heater will not burn correctly.
- **Gas Supply:** Is your gas turned on? Do you have an ample supply of gas?
- **Dual Fuel:** If you are operating a dual fuel model on Natural Gas, have you turned the gas selector valve on the back of the heater to NG and hooked to the NG inlet?
- **Dust & Dirt:** This heater does require some cleaning. If the pilot light will not stay lit or if one brick is not as bright as another, your heater is probably due for a good cleaning. Replacement of the thermocouple or pilot assembly is generally not needed. **Review Heater Maintenance in the owners manual.**

While we want everyone to be completely satisfied with their purchase it is impossible to warranty problems occurring from improper use or installation or a lack of maintenance.

KozyWorld® Warranty Registration

Appliance Model # _____ Serial # _____
Date of Purchase _____

IMPORTANT: We urge you to fill out your warranty registration card within ten (10) days of date of purchase, complete with the entire serial number which can be found on the rating plate. Retain this portion of the card for your records.

World Marketing of America, Inc.

PO Box 192, Route 22 West
Mill Creek PA 17060-0192
(Tel) 1-800-776-9425
Register Online At:
www.worldmkting.com

SAVE THIS CARD!

Place
Postage
Stamp
Here

World Marketing of America, Inc.

PO Box 192

Mill Creek PA 17060-0192